

COMMERCIAL

Ingrebourne Valley Golf Club, Sports & Leisure Facility

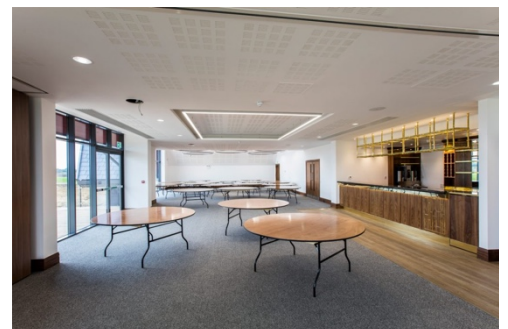

Horizon Construction was delighted to complete this commercial construction project to build a high specification bespoke golf club facility. It serves two 18-hole golf courses and provides leisure facilities, including gymnasium, spin and aerobics studios and dining spaces for members and events/weddings.

-  Location: Rainham, Essex
-  Client: Ingrebourne Valley
-  Architect: BRD Architects
-  Project Manager: Hoggarth Cook Partnership
-  Project Value: £4.5m